

# LED linear lighting

LUMOLUX

## Installation 1



### Step 1

Fix the suspension rope onto the hook on the ceiling;

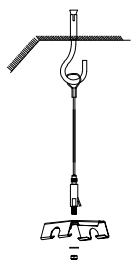

### Step 2

- Remove the nut on the suspension rope and fix the installation buckle on the lock head;
- Adjust the length of the steel wire rope according to actual needs;



### Step 3

Fix the light fixture onto the buckle according to the card position;

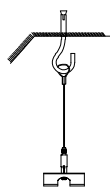
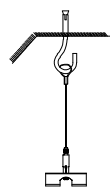

### Step 4

- Align the lighting fixtures as shown in Figure ①;
- Then install the lighting fixtures flat, as shown in Figure 2 below;
- Install hardware buckles at the joint, as shown in Figure ③ on the right;

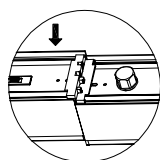

①

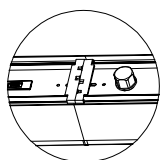

②

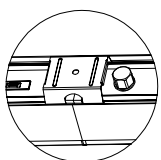

③

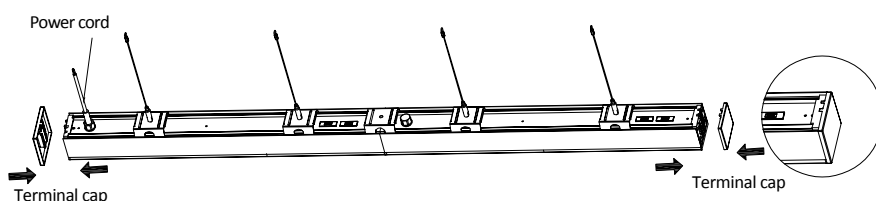

### Step 5

- Install tail covers at both ends of the lighting fixture;
- Remove the safety helmet from the power connector and connect it to the power cord;
- Assembly completed;

## Installation 2

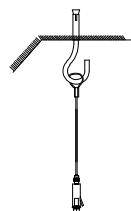

### Step 1

Fix the suspension rope onto the hook on the ceiling;



### Step 2

- Remove the nut on the suspension rope and fix the installation buckle on the lock head;
- Adjust the length of the steel wire rope according to actual needs;

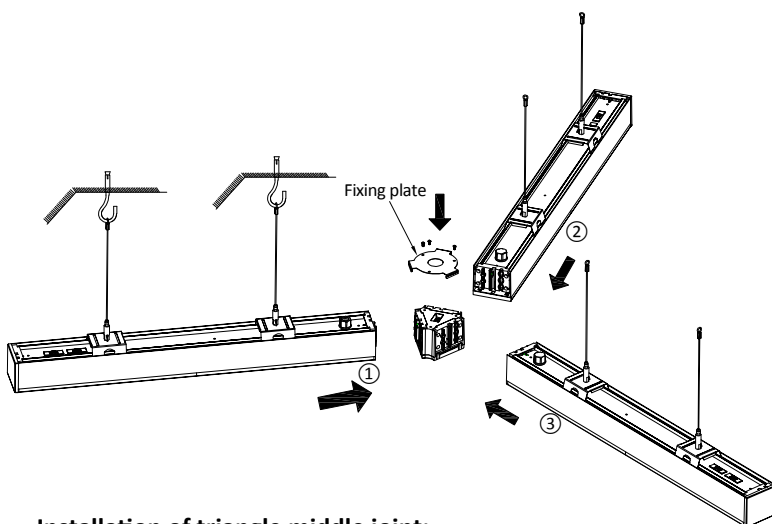

### Installation of triangle middle joint:

- Install the triangle in the middle to lamp ①, and then install lamps ② and ③ into different sides of the middle in sequence;
- Install the fixing plate in the middle of the triangle and secure it with screws;
- Install tail covers on both ends of the lighting fixture;
- Remove the safety helmet from the power connector and connect it to the power cord;
- Installation completed;

