

Instruction manual for Lexor LED luminaire

Safety Information:

1. Installation must be performed by a qualified electrician.
2. Ensure the luminaire is disconnected from the power source during installation. Connect the power wires according to the wire labels.
3. Do not connect the power supply before proper installation.

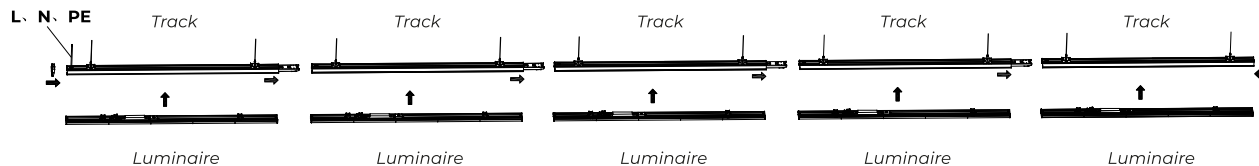

Step 1: Install the suspension device

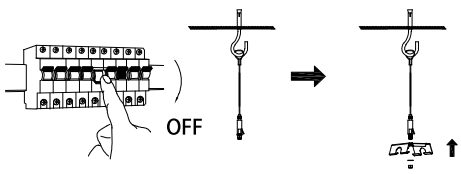

2. Remove the nut from the suspension rope and secure the mounting clip to the lock head. Adjust the wire rope length as needed.

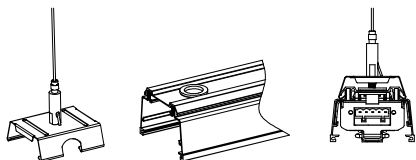

3. Snap the mounting clips into the track line array.

Wire diagram of triple circuits function

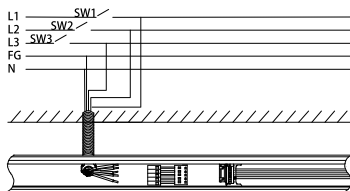

This Triple Circuits function offers to control lighting ON/OFF by three switches SW1, SW2, SW3 which are connected by live lines L1, L2, L3.

Step 2: Connect the tracks

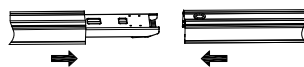

1. Keep both tracks at the same horizontal level, then push them together to join them.

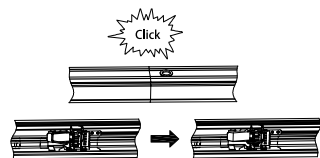

2. Fasten the metal buckle onto the metal base of the mating terminal.

Emergency light connection diagram

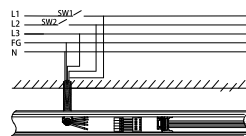

Emergency lighting fixtures are controlled via two switches (SW1, SW2) for turning illumination on/off. These switches are connected to live wires L1 and L2. L3 provides continuous mains power for emergency battery charging and monitoring mains voltage.



Step 3: Connect the power cord

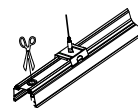

1. Cut an opening in the rubber plug and feed the power cord through the plug into the track.

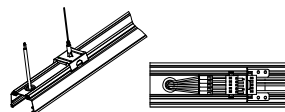

2. Connect the power cord to the terminals according to the labels on the wires, then attach the connector to the connector on the rail.

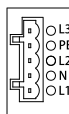

*Note: Emergency lighting fixtures must be wired according to the emergency light source wiring diagram. L3 serves as the charging and detection line for the fixture's built-in battery. L3 should remain connected to the mains power supply at all times to charge the built-in battery and detect mains voltage signals. In the event of a mains power failure, the detection line transmits the power outage signal to the built-in battery. The built-in battery then supplies power to the emergency lighting fixture, causing it to illuminate.

Step 4: Install the light fixture

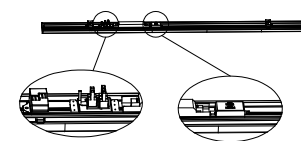

CCT:3000K • 4000K • 6000K
Power:42W • 50W • 62W • 70W

1. Before installing the lighting fixture, slide the terminals to select the phase: L1, L2, L3;
2. Set the power level using the DIP switches to select the product's power output.
3. Slide the DIP switch to select the desired CCT.

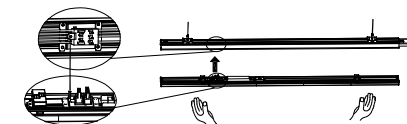

4. As shown in the figure, align the positioning pins of the luminaire with the positioning holes on the track, ensuring the male and female connectors are in the correct position, then secure the luminaire to the track.

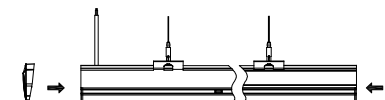

5. Install end caps on both ends of the luminaire.